

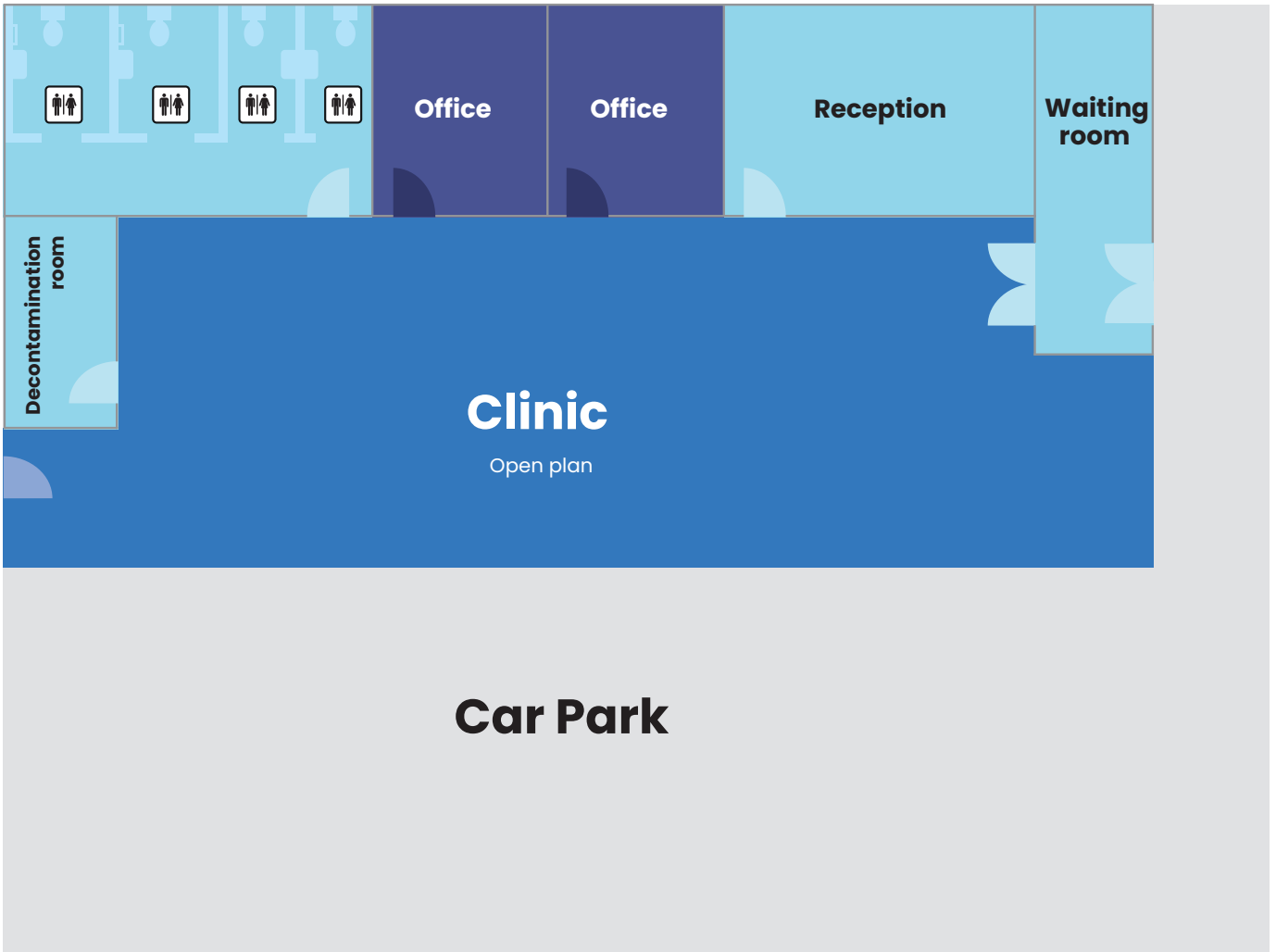

***PODIATRY
CLINICS***

DURHAM CAMPUS MAP

CAMPUS KEY ● Ground Floor ● Toilets



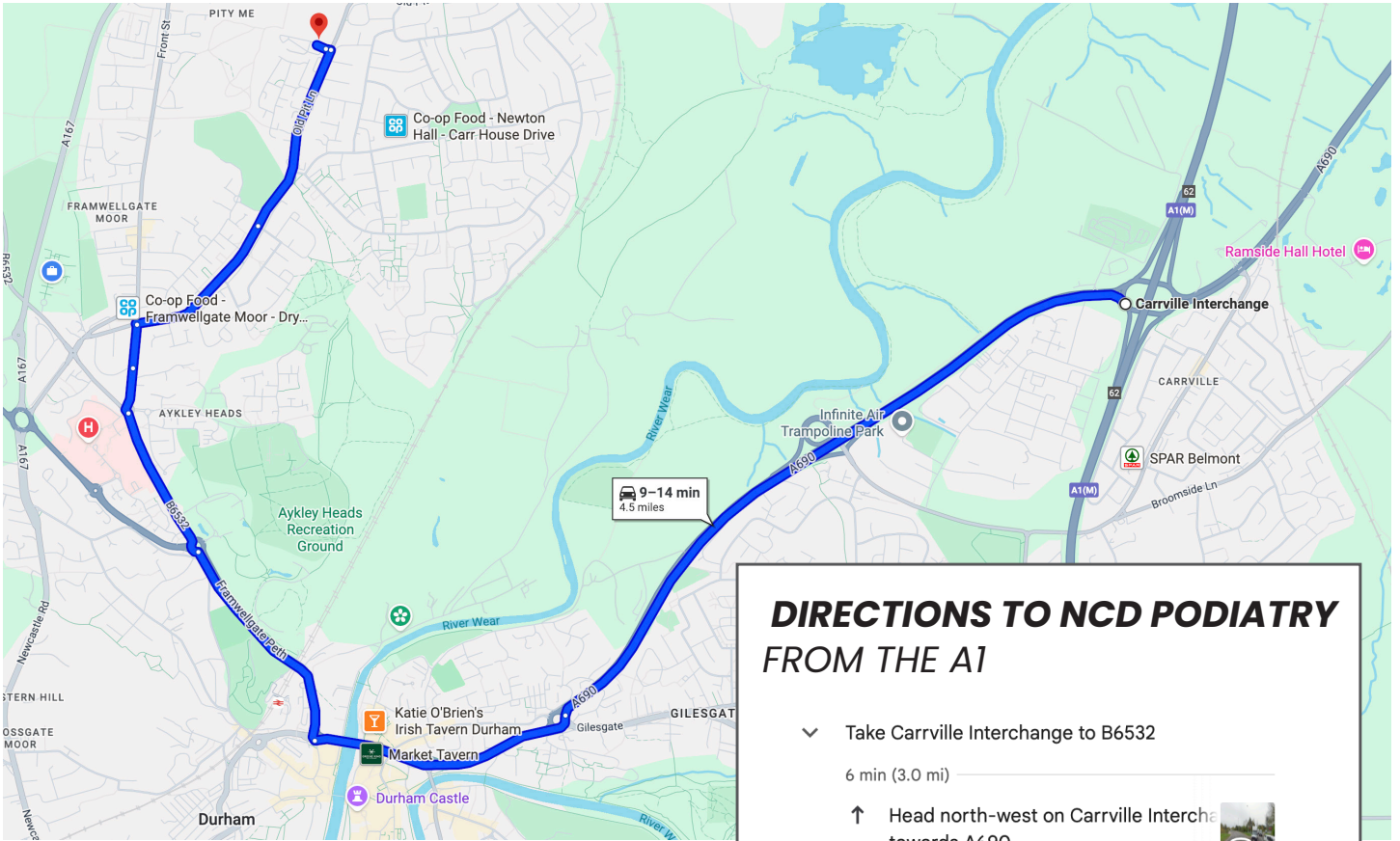

DIRECTIONS TO NCD PODIATRY FROM THE A1

- ✓ Take Carrville Interchange to B6532
 6 min (3.0 mi)
 - ↑ Head north-west on Carrville Interchange towards A690
 
 1.8 mi
 - ↻ At Gilesgate Roundabout, take the 3rd exit onto Leazes Rd/A690
 0.7 mi
 - ↗ Use the left lane to turn right onto Framwellgate/A691
 ⓘ Continue to follow A691
 0.6 mi
- ✓ Continue on B6532 to your destination in Pity Me
 4 min (1.5 mi)
 - ↻ At the roundabout, take the 3rd exit onto B6532
 0.4 mi
 - ↻ At the roundabout, continue straight onto Durham Rd
 0.1 mi
 - ↑ Continue onto High Carr Rd
 0.1 mi
 - ↻ At the roundabout, take the 3rd exit onto Finchale Rd
 0.4 mi
 - ↑ Continue onto Old Pit Ln
 0.5 mi
 - ↶ Turn left
 72 ft
 - ↗ Slight right
 ⚠ Restricted-usage road
 ⓘ Destination will be on the right
 121 ft

TRAVEL VIA CAR:

Low Carrs Lodge, Finchale Rd,
Durham DH1 5HE

NEAREST TRAIN STATION:

Durham (DHM)

BISHOP CAMPUS MAP

CAMPUS KEY ● Ground Floor  Toilets

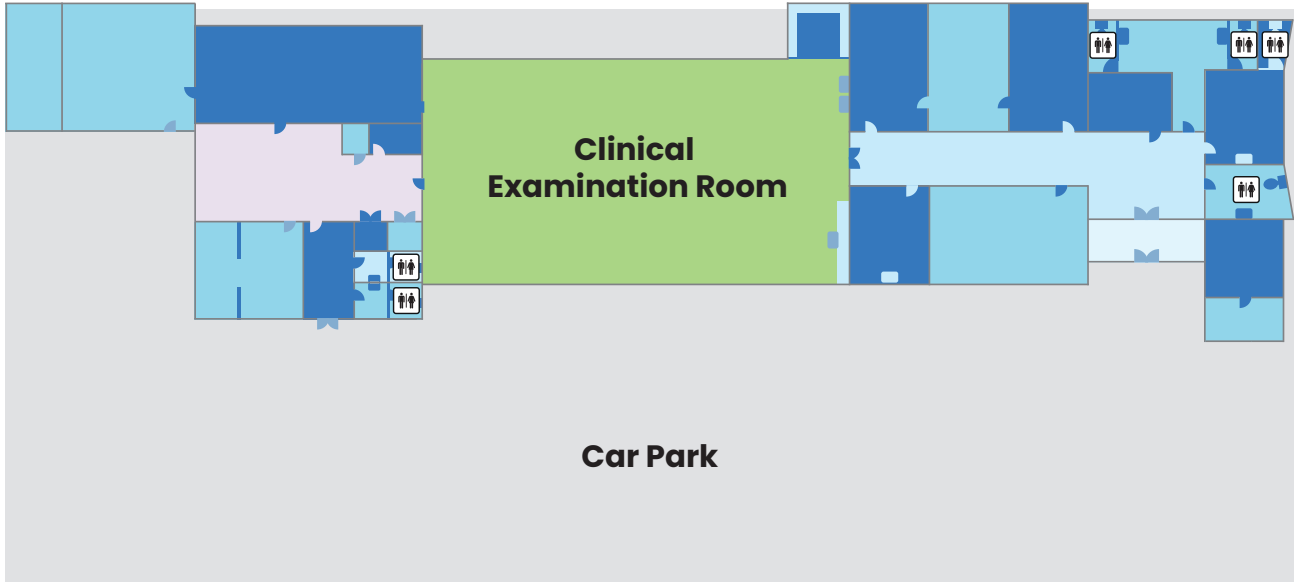

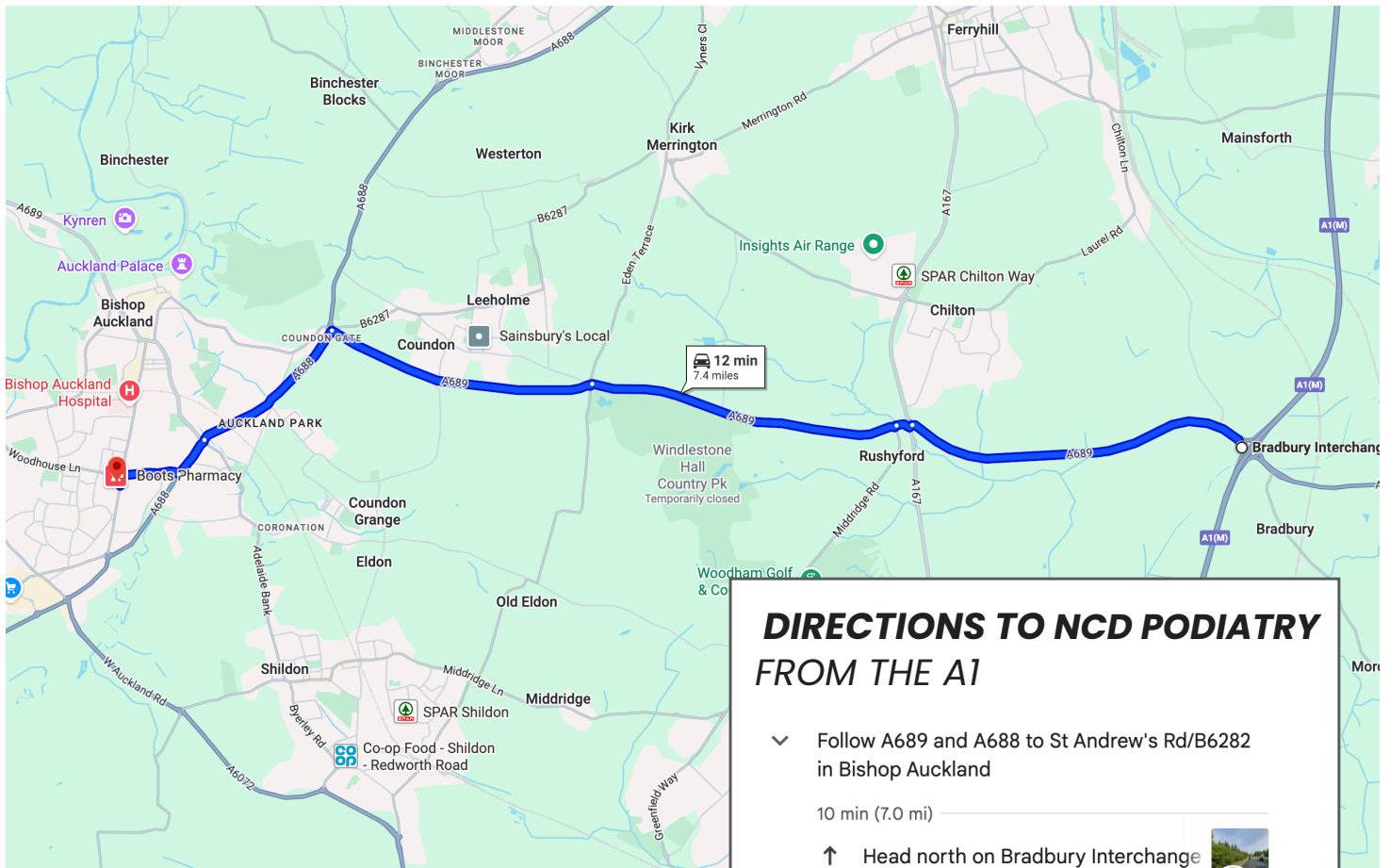

DIRECTIONS TO NCD PODIATRY FROM THE A1

- ✓ Follow A689 and A688 to St Andrew's Rd/B6282 in Bishop Auckland

10 min (7.0 mi)

- ↑ Head north on Bradbury Interchange



30 ft

- ↻ Exit the roundabout onto A689

2.1 mi

- ↻ At the roundabout, take the 3rd exit and stay on A689

0.1 mi

- ↻ At the roundabout, take the 2nd exit and stay on A689

1.9 mi

- ↻ At the roundabout, take the 2nd exit and stay on A689

1.6 mi

- ↻ At the roundabout, take the 1st exit onto A688

Go through 1 roundabout

1.0 mi

- ↻ At the roundabout, take the 2nd exit and stay on A688

0.3 mi

- ✓ Continue on St Andrew's Rd/B6282. Drive to Watling Rd

2 min (0.4 mi)

- ↪ Turn right onto St Andrew's Rd/B6282

0.3 mi

- ↵ Turn left onto Watling Rd

Destination will be on the right

315 ft

TRAVEL VIA CAR:

Watling Rd, Bishop Auckland DL14 6RP

NEAREST TRAIN STATION:

Bishop Auckland (BIA)